

65 Pine Street Chippendale NSW

3  1 

Nestled on a serene, tree-lined street, this exceptional terrace home seamlessly blends charming period details with smart modern updates to offer a superb inner-city lifestyle. Only within minutes walk to Central Park Mall, Broadway Shopping Centre, UTS, Sydney Uni, Spice Alley, Central Station, Chinatown, Darling Harbour, parks, eateries and shops.

The Torrens title home is situated in one of Chippendale's most sought-after streets, offering a lifestyle desirable to both homeowners and investors.

Main Features:

- ** Three spacious bedrooms spread over two levels
- ** Expansive lounge and dining areas with high ceilings

Type : House
Price : Contact Agent
Land Size : 108.6 sqm
View : <https://www.hspartners.com.au/8141829>



Andy Haisheng Shi
02 9643 5888



Angela Qiuling Zhang
02 9643 5888

[For full version visit the website](https://www.hspartners.com.au)

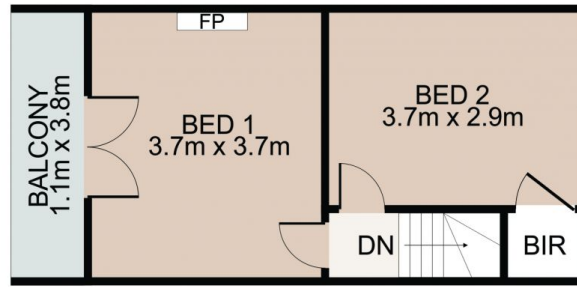

First Floor

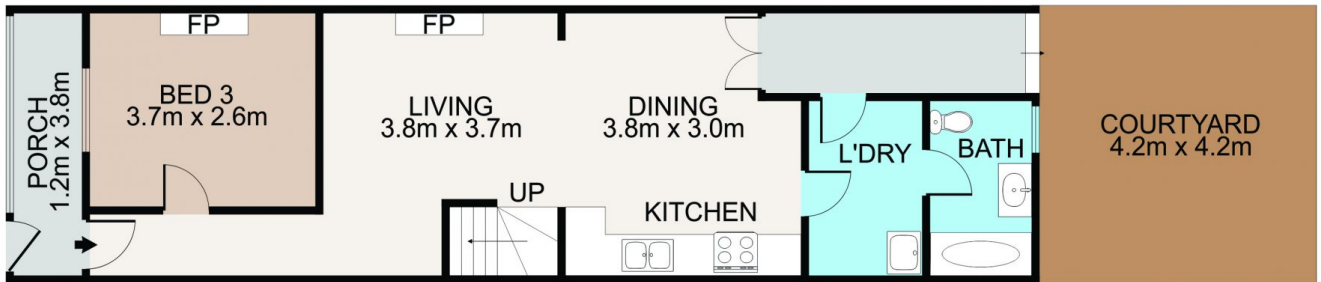

Ground Floor

65 Pine Street, Chippendale



Scale in metres. Indicative only. Dimensions are approximate. All information contained herein is gathered from sources we believe to be reliable. However we cannot guarantee its accuracy and interested persons should rely on their own enquiries